

Grade-B

Stover®-equivalent Lock

Nuts

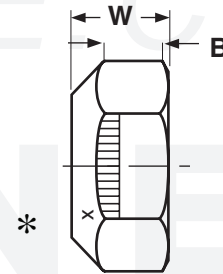
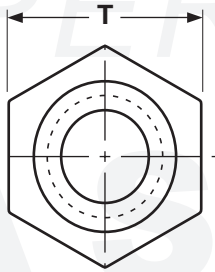

GRADE B AUTOMATION STYLE LOCK NUTS

RB&W Corp.

| Nominal Size in Inches | T | | | W | | B |
|------------------------|--------------------|--------|--------|-------------------|-------|------------|
| | Width Across Flats | | | Overall Thickness | | Hex Height |
| | Nom | Max | Min | Max | Min | Min |
| 1/4 | 7/16 | 0.4385 | 0.428 | 0.257 | 0.243 | 0.145 |
| 5/16 | 1/2 | 0.5020 | 0.489 | 0.302 | 0.292 | 0.166 |
| 3/8 | 9/16 | 0.5645 | 0.551 | 0.377 | 0.360 | 0.198 |
| 7/16 | 11/16 | 0.6895 | 0.675 | 0.430 | 0.410 | 0.223 |
| 1/2 | 3/4 | 0.7520 | 0.736 | 0.510 | 0.490 | 0.262 |
| 5/8 | 15/16 | 0.9395 | 0.922 | 0.645 | 0.621 | 0.329 |
| 3/4 | 1-1/8 | 1.1270 | 1.088 | 0.750 | 0.702 | 0.382 |
| 7/8 | 1-5/16 | 1.3145 | 1.2690 | 0.862 | 0.810 | 0.450 |
| 1 | 1-1/2 | 1.5020 | 1.4500 | 0.958 | 0.902 | 0.513 |

| | |
|--------------------------------|--|
| Description | <i>Grade-B Automation Lock Nut:</i> An all-metal, one-piece hex nut, thicker than a Grade-C across the flats, which derives its prevailing torque characteristics from controlled distortion of its top threads from their normal helical form to a more elliptical shape. |
| Applications/Advantages | <i>Grade-B:</i> These nuts are reusable and can withstand temperatures of up to 450°F. The conical-shaped top enables this nut to be used with an automatic feeder. The Grade-B can be used with low or medium carbon steel screws (i.e. a SAE Grade-2 or Grade-5). |
| Material | Low carbon steel. |
| Proof Load | 120,000 psi. |
| Plating | See Appendix-A for plating information. |

*Product standards require all grade-marked nuts 1/4" diameter and larger to have a raised or depressed insignia identifying its manufacturer. "X" represents one location such a marking may appear.